



LUXURY POWER CATAMARAN

Ref938

Apollo 65 (2008)

Jet Tern marine Sophie Yachts

Located: China

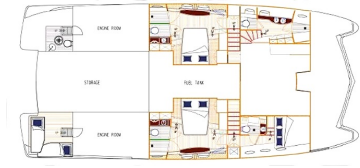

LUXURY POWER CATAMARAN

Apollo 65 (2008)
Jet Tern marine Sophie Yachts

Length 20 M (63.0')
Located: China

Ref938

\$ 1 299 000
MANAGEMENT PROGRAM



Type	Modern
Propulsion	Power
Hull	Catamaran
Length	20m (63.0')
Beam	9m (29.0')
Draft	2m (4.4')
Hull Material	Composite
Engine	2 / Caterpillar Marine / C18
Engine HP	2x1000
Guests	8
Guest Cabin(s)	4
Built/Refit	2008/2013
Builder	VPLP

Apollo 65 (2008)

Jet Tern marine Sophie Yachts

Located: China

Comments: THE FIRST OF THE APOLLO SERIE

Totally New from shipyard refit Sophie is sold as a new boat with a full 2 years Shipyard warranty. She has been used as a demo boat at boat shows in the South of China. She will be refurbished as a totally new boat before leaving the factory-New paint job and refurbishing of interior. Save the two years wait !!
"Our mission is to create the best Marine Villa - a beautiful, comfortable, safe and reliable second home Transatlantic Yacht , very easy to move from one place to another anywhere in the world. "

ELEGANT, COMFORTABLE, LIGHT AND ABOVE ALL SPACIOUS!
THE APOLLO 65' OFFERS MUCH MORE GENEROUS PROPORTIONS THAN A CLASSIC MOTOR YACHT.

The total living area of 145m2 includes a magnificent owner's suite with bedroom, den, bathroom and a 180° view of the sea in the boat's main deck ; a feature only found in much larger megayachts.
"Our experiments were vigorously carried out by an International team of experts, who are accustomed to innovate and to satisfy the most demanding customers. "
Conceived par Stephane Poughon designed by Van Peteghem Lauriot Prevost and Richard Hein with an interior designed by Olivier Gibault.

WINDWARD ISLANDS GIVES YOU THE OPPORTUNITY TO DEVELOP A CREWED CHARTER BUSINESS THRU A TAILORED MANAGEMENT PROGRAM