



**NAUTITECH 441**  
NAUTITECH 441 Charter version (2014)

Ref1143

Nautitech

Located: France

Plan intérieur Nautitech 4 cabines

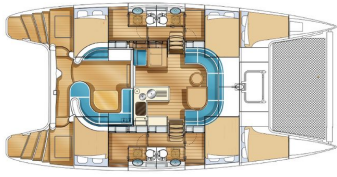

**NAUTITECH 441**  
NAUTITECH 441 Charter  
version (2014)

Nautitech

Length 13.5 M (45')

Located: France

Ref1143

€ 445 200



Type	Modern
Propulsion	Sail
Hull	Catamaran
Length	13.5m (45')
Beam	6.8m (23')
Draft	1.2m (4')
Hull Material	Fiberglass
Engine	2 / Yanmar / 3JH4-CE
Engine HP	39
Guests	8
Guest Cabin(s)	4
Built/Refit	2014/-
Builder	Nautitech shipyard / Mortain & Mavrikios

**Comments: A roof water recovery system:** This innovation is a real answer to autonomy when sailing long distances. The saline test after the first rainfall can be carried out either manually or automatically via a dedicated reservoir with a 400 litre capacity. This roof, as well as the possibility of fixing solar panels to it, considerably **increases the autonomy of the boat** during long crossings. The standard version can accommodate 10 passengers with 4 double cabins and 2 convertible fore peaks. The "**Exclusive finish**" provides greater comfort and makes your boat more attractive with a teak cockpit, specific upholstery, a beautifully crafted finish and additional equipment.

Windward Islands Yachting & Travel, FRANCE, SIRET 80739377200049

**Contact:** [brokerage@windward-islands.net](mailto:brokerage@windward-islands.net)

**Phone:** +33 4 93 38 12 14