



## ANTARES

Royal Huisman Sailing Yacht 131ft (2005)

Royal Huisman

Ref1599

Located: Spain

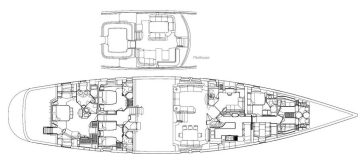

## ANTARES

Royal Huisman Sailing  
Yacht 131ft (2005)

Royal Huisman

Length 40.0 M (132')

Located: Spain

Ref1599



€ 9 990 000

Type	Modern
Propulsion	Sail
Hull	Mono
Length	40.0m (132')
Beam	8.8m (29')
Draft	4.2m (14')
Hull Material	Aluminium
Engine	1 / Caterpillar Marine / C18
Engine HP	715
Guests	10
Guest Cabin(s)	4
Crew Cabin(s)	3
Built/Refit	2005/2022
Builder	Bill Dixon
Availability Date	11-Apr-2025

Windward Islands Yachting & Travel, FRANCE, SIRET 80739377200049

**Contact:** [brokerage@windward-islands.net](mailto:brokerage@windward-islands.net)

**Phone:** +33 4 93 38 12 14

## ANTARES

Ref1599

Royal Huisman Sailing Yacht 131ft (2005)

Royal Huisman

Located: Spain

**Comments:** "ANTARES" is a 40-meter sailing yacht, designed to offer a navigation experience combining elegance, performance, and refinement. Built by Royal Huisman in 2005, it underwent a complete refit in 2022, incorporating modern upgrades while preserving its exceptional artisanal craftsmanship.

Its aluminum hull and superstructure ensure stability, robustness, and durability, guaranteeing smooth and secure sailing across the world's oceans. Its sophisticated exterior design, crafted by Dixon Yacht Design, features sleek and elegant lines, while its luxurious interior, designed by Rhoades Young Design, combines modernity and absolute comfort in every detail.

**ANTARES** boasts four sumptuous cabins, accommodating up to 10 guests, offering an intimate and refined setting. Its spacious living areas and high-end amenities make it a true haven of relaxation and indulgence, perfect for unforgettable cruises where luxury and serenity come together.

### Key Points:

- **Built by Royal Huisman** for world cruising.
- **Full refit in 2022**, including significant upgrades.
- **Four staterooms** accommodating up to **10 guests**, perfect for families.
- **Spacious master suite** with a high-end en-suite bathroom.
- **Ketch rig**, ensuring excellent sailing performance and versatility.
- **360-degree panoramic deckhouse** with a convertible dining space.
- **Proven durability**, extensively cruised in the South Pacific.
- **Art Deco-inspired interior**, elegantly modernized.
- **Aluminum construction**, offering exceptional longevity and robustness.

**Complete brochure / inventory on request.**