



KOKUMDO
Nautitech 47 (2005)

Ref. 960

Nautitech

Located: Martinique

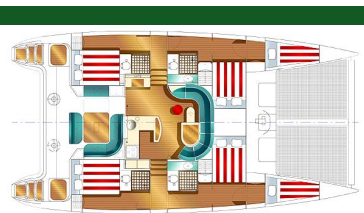

KOKUMDO
Nautitech 47 (2005)
Nautitech

Length 15 M (47.0')
Located: Martinique

Ref. 960

€ 270 000
approx \$ 333 952

MANAGEMENT PROGRAM

AVAILABLE FOR CHARTER



Type	Modern
Propulsion	Sail
Hull	Catamaran
Length	15m (47.0')
Beam	8m (25.0')
Draft	1m (3.0')
Hull Material	Fiberglass
Engine	2 / Yanmar / J4H4E
Engine HP	54

PAX	12
Guest Cabin(s)	6

Built/Refit	2005/-
Builder	Nautitech Shipyard

Comments: Its sleek line makes it different from any other catamaran. This is the guarantee that you are on a real yacht whose seaworthiness is beyond reproach. Its thin hulls do not prevent there being an impressive amount of space, due to the cockpit and saloon being on the same level. What is most impressive when you climb aboard for the first time, is the huge saloon looking to the exterior, its U-shaped and spacious galley and the panoramic view. It is certainly one of the finest catamarans on the market. Built in Lorient, it has been the subject of constant improvement. The standard version has 4 double cabins and 2 fore peaks which can be fitted out, allowing berths for 12 people. The optional "Exclusive" finish also gives greater comfort and aesthetic quality to your boat, such as teak cockpit, high quality outdoor upholstery, alcantara, top-of-the-range finish.